

long kiln

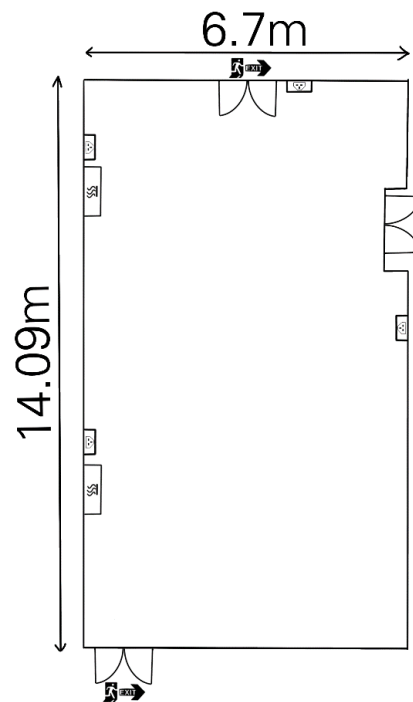

The Long Kiln Gallery provides a blank canvas for your event. With white walls, wooden floor and skylights, the room is light, bright, and airy. As well as being an excellent place to hold meetings for up to 80 seated guests, it provides a great space for exhibitions, workshops, and dance classes with an optional dance floor and barres. The space can also be used for music-based groups with the addition of an electric piano.

Facilities in the room include a retractable projector screen and blackout blinds. There are toilet facilities and a workshop style sink conveniently located in the corridor outside the gallery.

useful to know:

room length:	14.09m	room capacity:	80 seated
room width:	6.7m		50-80 banquet seating
daylight:	yes		30-35 meeting layout
blackout:	yes		
power sockets:	20		
wheelchair access:	fully accessible / via Barley Room		
other	pa system available, screen facilities		

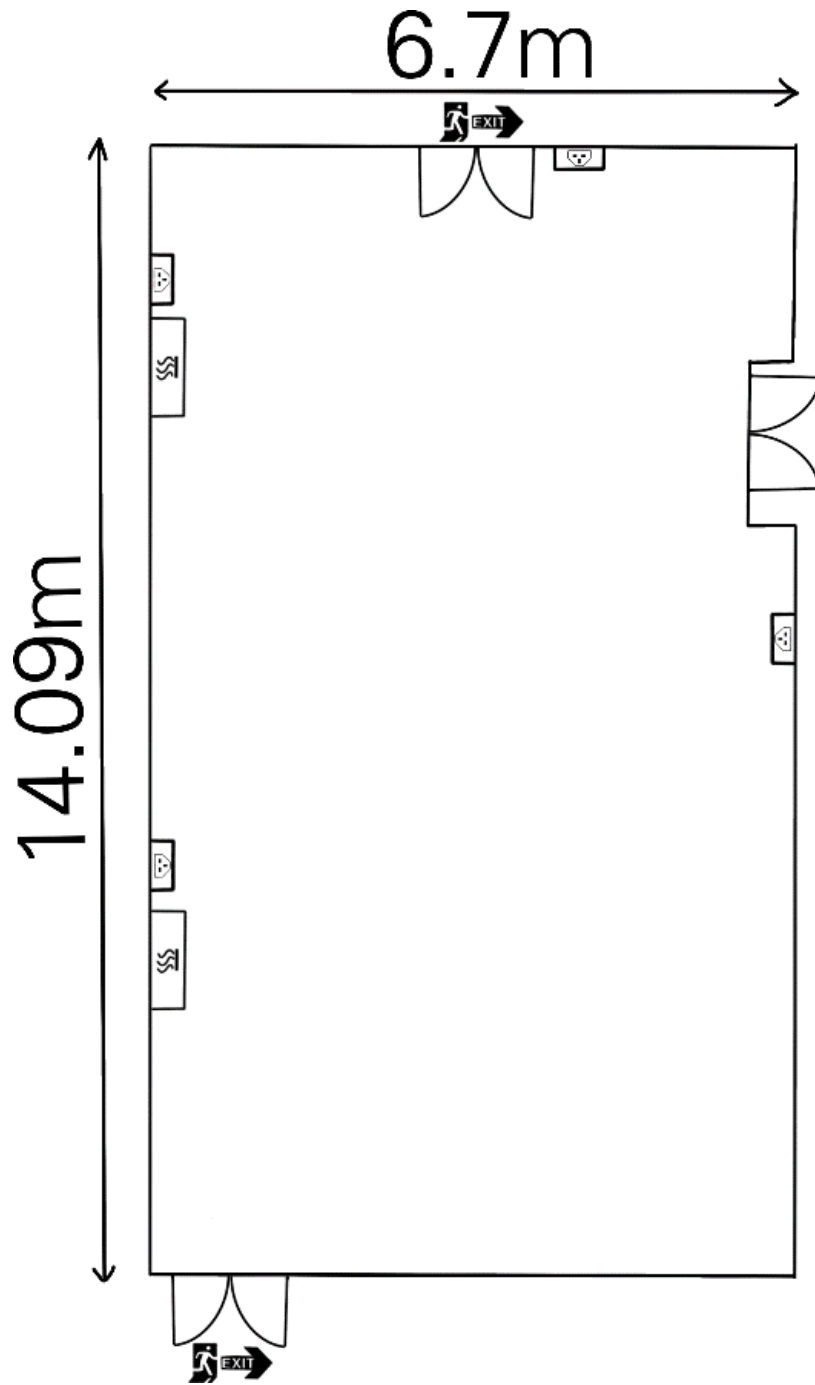

-  Bar
-  Window
-  Plug Socket
-  Heater
-  Double Door
-  Door
-  Pillar
-  Fire Escape
-  Toilet