

Tech Spec - Great Hall - Farnham Maltings:

Our Great Hall venue can be configured in several ways, the spec includes information for events on stage and on the flat floor. If you would like to discuss any details of the tech spec, please get in contact with our technical manager – Ben Rayner (ben.rayner@farnhammaltings.com). Some items may be subject to additional charges.

Please also see our CAD drawings which depict our different layouts. A .dwg file can be requested to create venue specific plans from our layered 3D file.

Lighting control:

ETC Ion XE with, 2 monitors running 3D augment.

2 x Zero 88 Chilli dimmers, each with 24 x 10A ways of dimming – (thru 48 splittable patch to lighting bars)

Sound Control:

Behringer X32 digital sound desk

Behringer S32 stage box (32 in/16 out)

plus 6 additional line in/output at desk,

Mac Mini (High Sierra 10.13.6) running Qlab 4 (Licence for multiple uses must be purchased by the hirer)

CD player

3.5mm Jack to stereo xlr

Sound Infrastructure:

FoH - 3X Martin Audio 12" Torus constant curvature array per side

Martin Audio SX218 Duel 18" SX Subwoofer per side

DD6 front fills

2x Martin Audio 12" Torus constant curvature array delays per side

QSC PLX 3102 3100W power Amplifier

3x DB technologies Flexsys FM10 Active Monitors

2 x Wharfdale EVP-X12PM Active Monitors

2 x Wharfdale EVP-X12M Passive Monitors

2x Yamaha Passive Monitors

Yamaha p7000s 3200W Power Amplifier

Behringer S32 Digital Snake (32 In/16 Out via CAT5E tie from tech box to stage)

4x Turbosound TCX 15 Cabinets.

Comms:

3x Tech pro BP111 by Canford with single ear headsets

Canford base station.

Rigging:

FoH - 6 x winch motor lighting bars with a SWL of 150kg 2M Between Bars FOH – 10M Wide

Stage – Fixed Grid with a SWL 250kg consisting of 12x bars 1m apart upstage – downstage.

bars stage L – Stage R 1 m apart, 3 IWB's with 13a non dim power, 15a dimmable, and DMX on each IWB.

FoH Audio side bar 80KG. FoH Lighting Side bars 50KG.

4x boom base available (4x 2m, black bars)

Boom bars for outrigging (29x 0.5 M)

Clips (20)

Power and Patches:

1 x 32A 3phase, 1 x 32A single phase situated DSR, separate feeds.

2 x 13A SR and SL rated at 20A

DSR – patch panels for sound and AV from tech box (2x cat 5e, 1x DMX in, 4x DMX out Universe 1, 1x out universe 2, 14x XLR inputs, 4x XLR returns)

LX power is on 15A dimmable sockets, 13a non dim fitted to stage lighting bars.

Universe 1 – Split to bars 1-6, to stage – split to bars 1-3.

Universe 2 - feed to houselights, split from HL dimmer to stage and FoH Bar 1-4.

Microphone Stock:

5 x Shure sm58

2 x Shure sm58s

6 x Shure sm57

1 x Shure Beta 91a

1 x Shure Beta 52A

1 x IMG Stage line Drum microphone set

2 x Beyerdynamic m58n

4 x Rode NT5

2 x Rode NT1a

4 x Behringer DI100

4 x Radial Pro DI – Passive DI Box

Lighting Equipment (Flexible):

8 x ETC Source 4 15/30

5 x ETC Source 4 25/50

4 x 1KW Starlette F

MVS Le Maitre Hazer

8 x Equinox Colour Raider Uplighters

2 x Stairville Wild Wash 132 LED RGB

2 x 1KW spotlight F

2 x ETC Lustr 2 25/50 LED

22 x Parcan (CP62)

Martin Jem Mini Hazer Pro

2 x Cameo Thunder Wash LED 600 RGBW

Lighting Equipment (Rigged not moveable – see fixed rig plan):

6 x ETC Source 4 15/30

6 x ETC Colorsource Par

9 x Prolights Cob pars FC

4 x ETC Lustr 2 25/50

3 x Luma 700

6 x 1KW Source Four F

5 x ETC Source 4 25/50

Other:

Studio Space/flat floor - black box

Black Harlequin dance floor available on request.

Black wool serge drapes on tab track form a black box playing space.

2 sets of legs are positioned on either side of the studio performance space.

Main Stage – black wool serge drapes at the rear, two sets of wing blacks or stage divider down of mid stage, full curtain track front tabs on hand winch control DSL.

Various modifications on these spaces are possible including 2M stage extensions, tiered staging, risers, and modified floor layouts.

5M front or rear projection screen. (Lose 2M playing space for rear projection).

4 Dressing Rooms available for hire.

Stage Quick reference measurements (for more detail please see CAD Drawing):

SR Door to Backstage Area 1.746 M Wide.
2.208 High

4.8 Meters Clearance to Grid.

SL Door to Backstage Area 1.683M Wide. 2.149 High

SL Door into Courtyard 2.59 M Wide. 2.024 M High
50cm Step up to stage level.

Stage: 12M Wide by 5M Deep (extensions available on request total 7M depth). 1.05M High
Largest Load in door in auditorium with access from courtyard measures W: 1.64 M H: 3.19M (steep ramp from courtyard).

Room Plan:

Flat Floor Playing Space - W 11.3m D 6.2m Clearance to grid 5.7m

Highlighted area can be used as a seated area for staged performances, or with the seats removed for flat floor studio events with the set line in line with the fire exit, the room can also be used as a flat floor space.

Curtain to create Black Box Studio Space: 

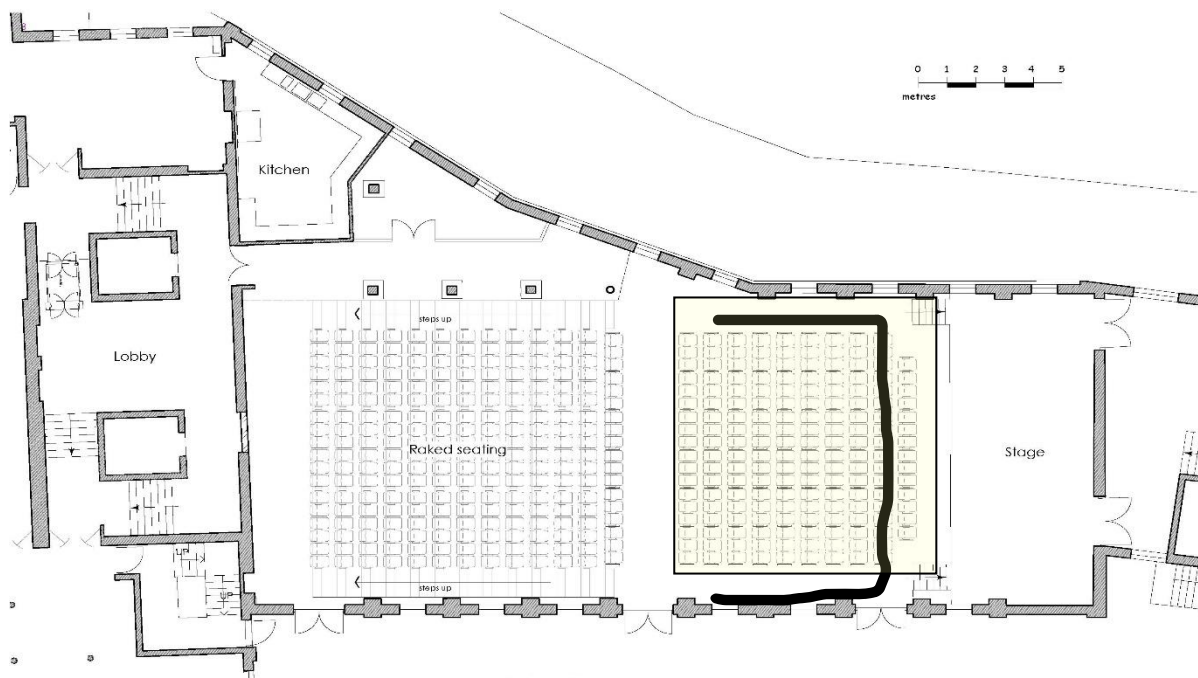

All Seating set out

FARNHAM MALTINGS
GREAT HALL PLAN
SCALE 1:100 @A3

LX BAR AND SOCKET LAYOUTL:

SWL: FoH bars 150KG. Grid above stage 250KG. FoH Audio side bar 80KG. FoH Lighting Side bars 50KG.

Patch:

3x Luma 700: @

129 – 147 100 – 118 187-205

S4 LED Lustr Direct: Flat Floor Wash @

250 – 257 265 – 272 280 – 287 295 – 302

Studio Cob FC: Stage Backlight @

420 - 427 380-387 444-451
412 - 419 388-395 436-443
404 – 411 396-403 428-435

Colour Source Par: Above Stage Wash @

375-379 360-364 355-359 350-354

Colour Source Par: Studio Back Light @

49-53 54-58 59-63

House Lights from nearest stage – Auditorium rear @

513 514 515 516

Jem Compact Hazer Pro: 3ch @212